

DC Quick change collets to suit DHP80/DHF80/DRF80 Collet chucks

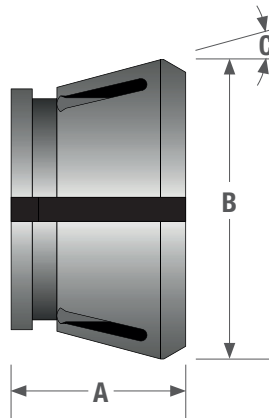

DC80 Varibore Collets

- Round, Hexagon, Square or Emergency types available
- Please specify which gripping surface you require – Serrated or Smooth
- Clamping tolerance of +/- 0.5mm
- Counter boring and special profile shapes are available upon request

Dimensions (Metric)

Part No.	A	B	C
DC80	53	114.5	15°

DC80 Round Collets

Nominal Gripping Diameter	Serrated Part Number	Smooth Part Number
7mm	DC80-R07	DC80S-R07
8mm	DC80-R08	DC80S-R08
9mm	DC80-R09	DC80S-R09
10mm	DC80-R10	DC80S-R10
11mm	DC80-R11	DC80S-R11
12mm	DC80-R12	DC80S-R12
13mm	DC80-R13	DC80S-R13
14mm	DC80-R14	DC80S-R14
15mm	DC80-R15	DC80S-R15
16mm	DC80-R16	DC80S-R16
17mm	DC80-R17	DC80S-R17
18mm	DC80-R18	DC80S-R18
19mm	DC80-R19	DC80S-R19
20mm	DC80-R20	DC80S-R20
21mm	DC80-R21	DC80S-R21
22mm	DC80-R22	DC80S-R22
23mm	DC80-R23	DC80S-R23
24mm	DC80-R24	DC80S-R24
25mm	DC80-R25	DC80S-R25
26mm	DC80-R26	DC80S-R26
27mm	DC80-R27	DC80S-R27
28mm	DC80-R28	DC80S-R28
29mm	DC80-R29	DC80S-R29
30mm	DC80-R30	DC80S-R30
31mm	DC80-R31	DC80S-R31

Nominal Gripping Diameter	Serrated Part Number	Smooth Part Number
32mm	DC80-R32	DC80S-R32
33mm	DC80-R33	DC80S-R33
34mm	DC80-R34	DC80S-R34
35mm	DC80-R35	DC80S-R35
36mm	DC80-R36	DC80S-R36
37mm	DC80-R37	DC80S-R37
38mm	DC80-R38	DC80S-R38
39mm	DC80-R39	DC80S-R39
40mm	DC80-R40	DC80S-R40
41mm	DC80-R41	DC80S-R41
42mm	DC80-R42	DC80S-R42
43mm	DC80-R43	DC80S-R43
44mm	DC80-R44	DC80S-R44
45mm	DC80-R45	DC80S-R45
46mm	DC80-R46	DC80S-R46
47mm	DC80-R47	DC80S-R47
48mm	DC80-R48	DC80S-R48
49mm	DC80-R49	DC80S-R49
50mm	DC80-R50	DC80S-R50
51mm	DC80-R51	DC80S-R51
52mm	DC80-R52	DC80S-R52
53mm	DC80-R53	DC80S-R53
54mm	DC80-R54	DC80S-R54
55mm	DC80-R55	DC80S-R55
56mm	DC80-R56	DC80S-R56

Nominal Gripping Diameter	Serrated Part Number	Smooth Part Number
57mm	DC80-R57	DC80S-R57
58mm	DC80-R58	DC80S-R58
59mm	DC80-R59	DC80S-R59
60mm	DC80-R60	DC80S-R60
61mm	DC80-R61	DC80S-R61
62mm	DC80-R62	DC80S-R62
63mm	DC80-R63	DC80S-R63
64mm	DC80-R64	DC80S-R64
65mm	DC80-R65	DC80S-R65
66mm	DC80-R66	DC80S-R66
67mm	DC80-R67	DC80S-R67
68mm	DC80-R68	DC80S-R68
69mm	DC80-R69	DC80S-R69
70mm	DC80-R70	DC80S-R70
71mm	DC80-R71	DC80S-R71
72mm	DC80-R72	DC80S-R72
73mm	DC80-R73	DC80S-R73
74mm	DC80-R74	DC80S-R74
75mm	DC80-R75	DC80S-R75
76mm	DC80-R76	DC80S-R76
77mm	DC80-R77	DC80S-R77
78mm	DC80-R78	DC80S-R78
79mm	DC80-R79	DC80S-R79
80mm	DC80-R80	DC80S-R80

DC80 Hexagon Collets

Available from 10mm to 70mm across flats sides of the hexagon in 1mm increments. Part number is **DC80-X****. Please state which size you require, smooth or serrated gripping surface is available.

DC80 Square Collets

Available from 10mm to 56mm across flats sides of the square in 1mm increments. Part number is **DC80-S****. Please state which size you require, smooth or serrated gripping surface is available.

DC80 Emergency Collets

Available only with 8mm, 20mm or 40mm or 60mm pilot holes. Part number is **DC80-E****. Please state which size you require.